

BEAM FOKKER DVII COMMON FRET PARTS LIST

- | | |
|--|---|
| 1. LACING STENCIL | 49. LIFTING HANDLES |
| 2. RAISED LACING | 50. STEP |
| 3. WING INSPECTION PANEL | 51. CONTROL HORNS (FOLDING) |
| 4. WING INSPECTION PANEL WITH HOLE FOR
CONTROL WIRE | 52. AILERON CONTROL HORNS (FOLDING) |
| 5. GROMETS | 53. LAP HARNESS ATTACHMENT HARDWARE |
| 6. FOOTSTEPS | 54. SHOLDER HARNESS ATTACHMENT HARDWARE |
| 7. ANEMOMETER | 55. LEATHER REINFORCEMENT GROMETS |
| 8. ANEMOMETER | 56. CONTROL COLUMN GRIP |
| 9. LIFTERS | 57. AUXILIARY THROTTLE |
| 10. LIFTER SPRING CAPS | 58. LEATHER REINFORCING |
| 11. MIRROR ADJUSTMENT BRACKET | 59. TRIGGER |
| 12. MIRROR BRACKET NUT | 60. FOOT PLATES |
| 13. MIRROR BRACKET | 61. LAP HARNESS |
| 14. STRUT ATTACHMENT PLATES | 62. HARNESS ADJUSTMENT HARDWARE |
| 15. BLAST CHANNELS | 63. HARNESS BUCKLES |
| 16. COOLING JACKET FRONT 1 | 64. COMPASS YOKE |
| 17. COOLING JACKET FRONT 2 | 65. COMPASS MOUNTING PANEL |
| 18. COOLING JACKET BACK | 66. COMPASS BRACKET |
| 19. COOLING JACKET | 67. COMPASS BRACKET SUPPORT |
| 20. MACHING GUN MOUNTING BRACKET | 68. COMPASS BEZEL |
| 21. AMMUNITION GUIDE SIDE 1 | 69. COMPASS SUPPORT |
| 22. AMMUNITION GUIDE BASE | 70. TURNBUCKLES |
| 23. AMMUNITION GUIDE SIDE 2 | 71. AILERON CRANK |
| 24. THROTTLE QUADRANT FRONT | 72. RUDDER BAR BRACKET |
| 25. THROTTLE QUADRANT MIDDLE | 73. RUDDER CABLE ATTACHMENT BRACKETS |
| 26. THROTTLE QUADRANT BACK | 74. RUDDER BAR TOP |
| 27. THROTTLE LEVER | 75. RUDDER BAR BOTTOM |
| 28. THROTTLE MOUNTING BRACKET | 76. RUDDER BAR STIRRUPS |
| 29. PROPELLER BOSS NUT | 77. RADIATOR EXTERIOR 1 |
| 30. PROPELLER BOSS | 78. RADIATOR EXTERIOR 2 |
| 31. AILERON CONTROL HORNS (GLUED) | 79. RADIATOR INTERIOR |
| 32. CONTROL HORN (GLUED) | |
| 33. MG COCKING MECHANISM (EARLY) | |
| 34. MG COCKING MECHANISM (LATE) | |
| 35. COCKING HANDLES | |
| 36. MG SPRING COVER | |
| 37. RADIATOR SHUTTER | |
| 38. AMMUNITION BELTS | |
| 39. SAFTEY | |
| 40. SAFTY LEVER | |
| 41. IGNITION CONTROL NUT | |
| 42. IGNITION CONTROL LEVER | |
| 43. IGNITION CONTROL BRACKET | |
| 44. MIRROR BEZEL | |
| 45. MIRROR | |
| 46. MIRROR WING PLATE | |
| 47. CROSS BRACING SUPPORTS | |
| 48. SHOULDER HARNESS | |

Assembling Instruction of Barry Berman`s Photo etched Parts

„In this case we used the Fokker D VII OAW Mid Production
parts“

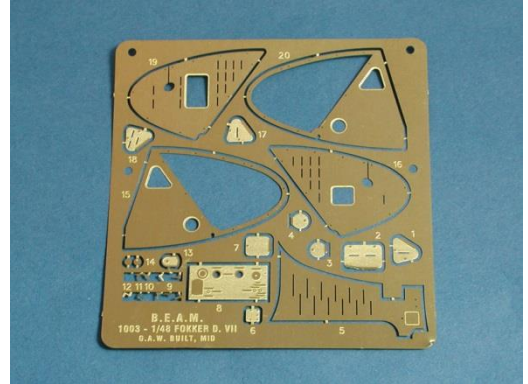
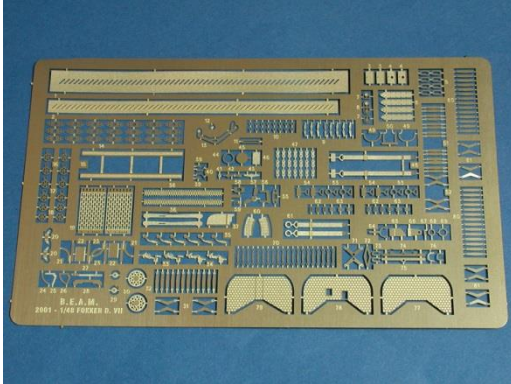

Step 1 Cockpitfloor

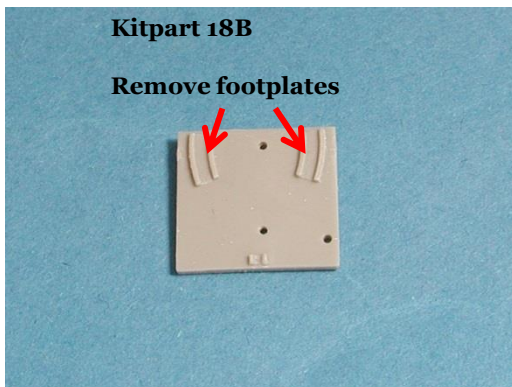

Picture 1

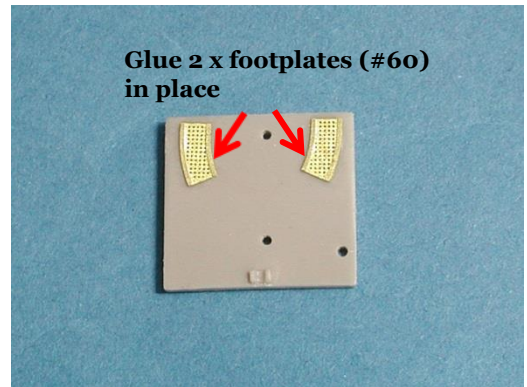

Picture 2

Step 2 Rudderbar

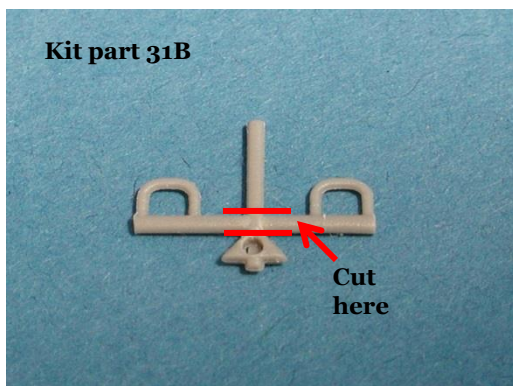

Picture 3



Picture 4

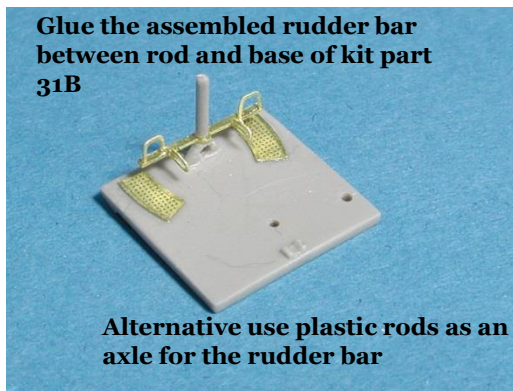

Picture 5

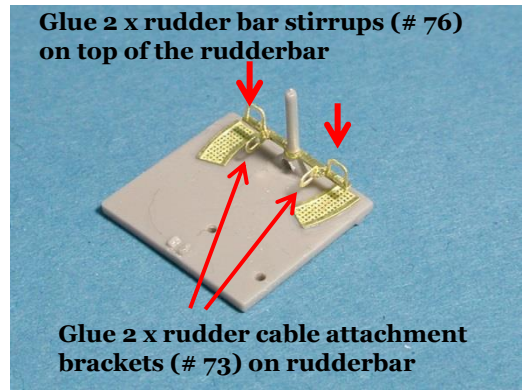

Picture 6

Step 3 Control column



Picture 7

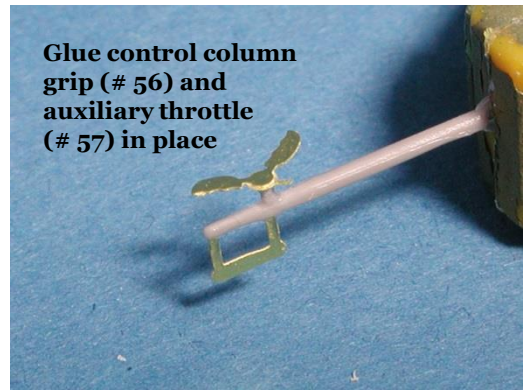

Picture 8

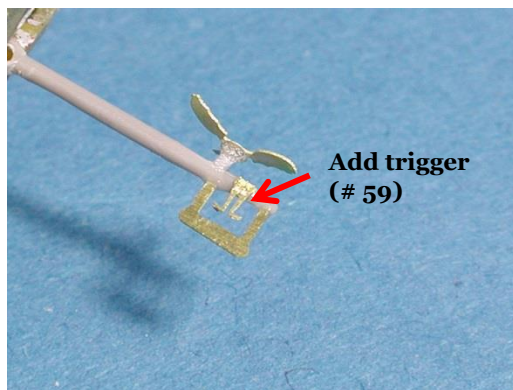

Picture 9



Picture 10

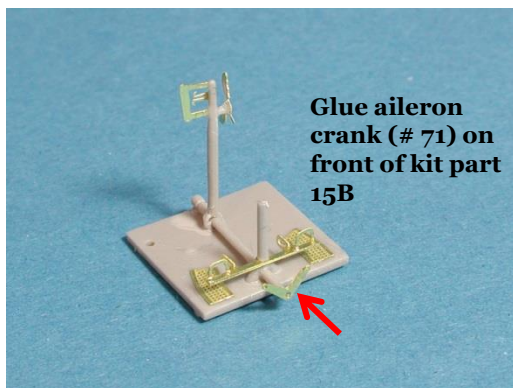

Picture 11

Step 4 Compass

Cut and clean up compass yoke (# 64)



Picture 12

Twist both rings 90°



Picture 13

Insert compass support (# 69)



Picture 14

Glue compass bezel (# 68) on top of compass support (# 69)



Picture 15

Remove all raised details (inclusive compass yoke) of kit part 25B



We have used a 2 mm plastic rod and filed in shape

Picture 16

Glue compass housing beneath compass support (# 69)



Picture 17

Assembled compass seen from above



Picture 18

Bend compass bracket (# 66) and glue it on compass mounting panel (# 65)

Compass bracket bend here



! Long side must be on right hand!

Use engraved line on mounting panel as a guide for glueing

Picture 19

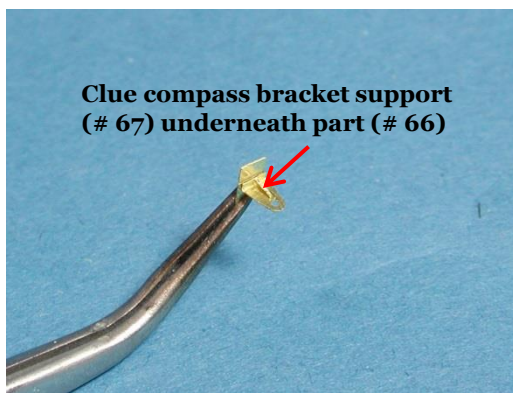

Picture 20

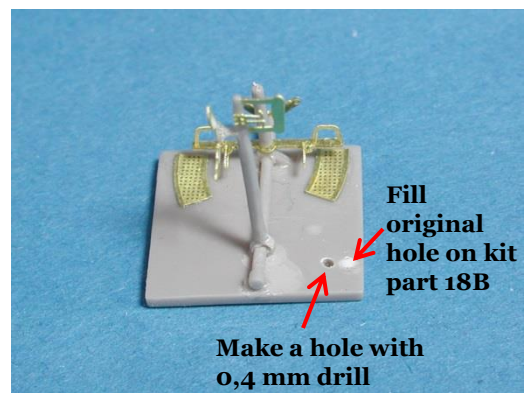

Picture 21

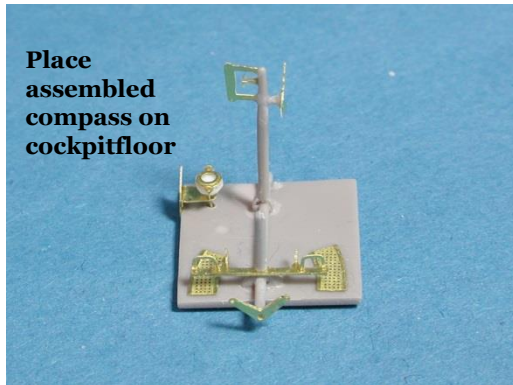

Picture 22

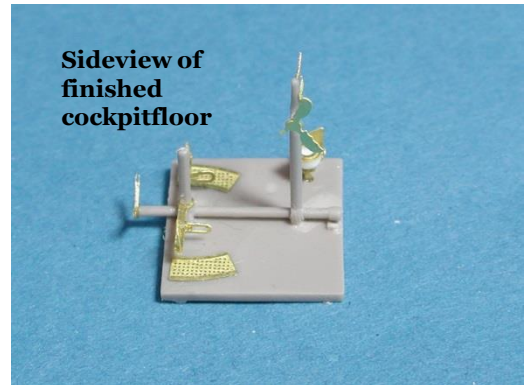

Picture 23

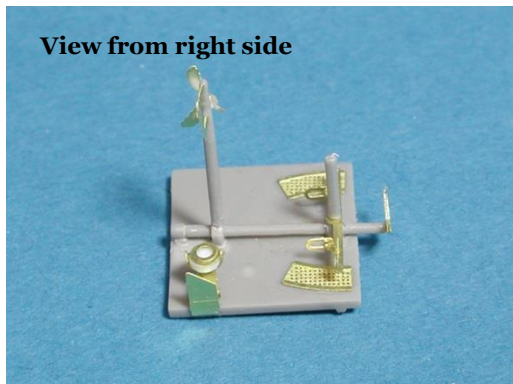

Picture 24

Step 5 Control Horns



Picture 25

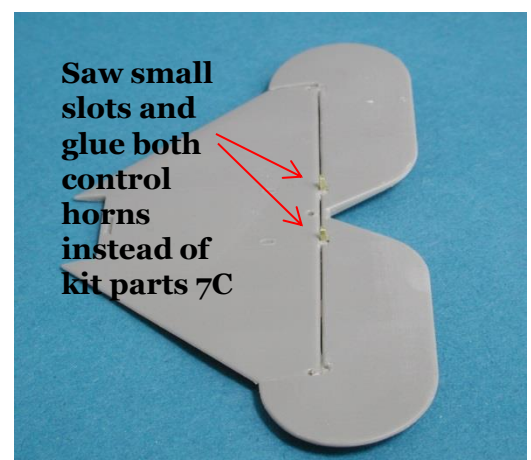

Picture 26

Step 6 Wing Inspection Panel

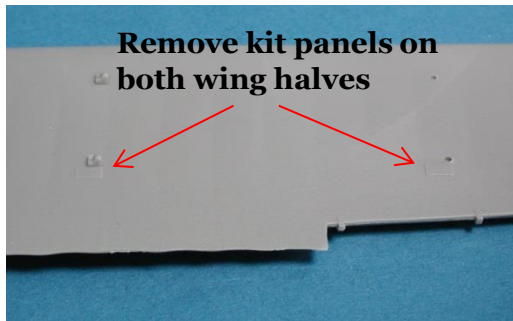

Picture 27

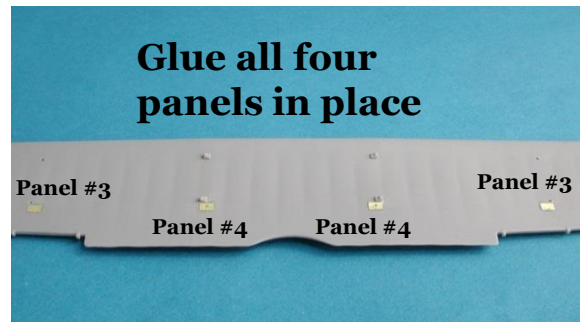

Picture 28

Step 7 Aileron Control Horns



Picture 29

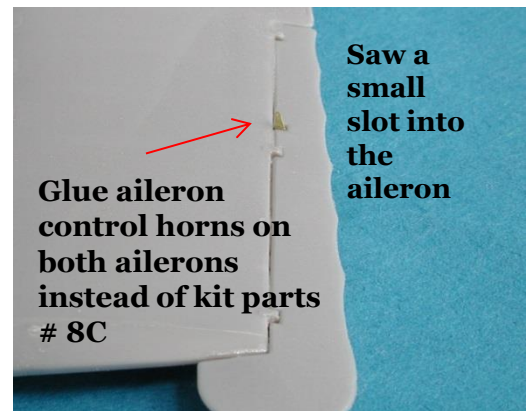

Picture 30

Alternative Step: Mirror

Please verify your reference material before using the mirror with your model

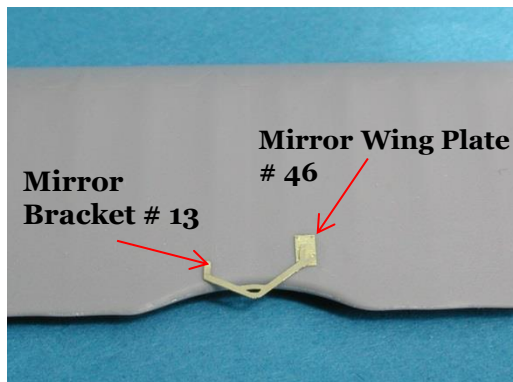

Picture 31

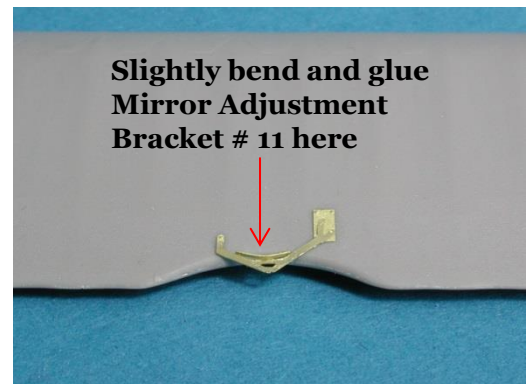

Picture 32



Picture 33



Picture 34



Picture 35

Step 8 Radiator

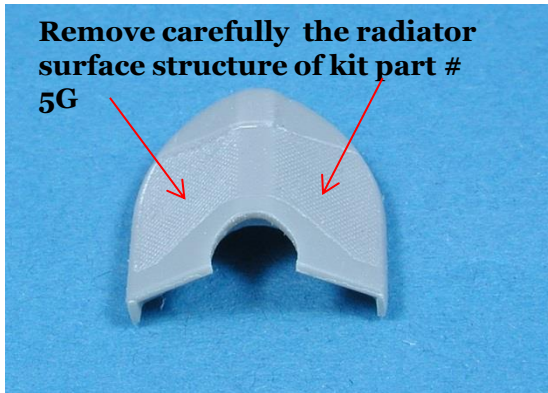

Picture 36

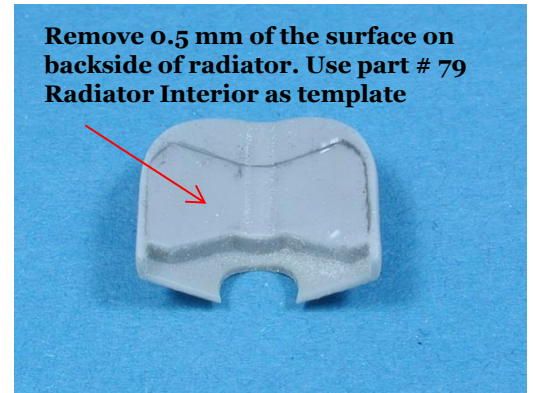

Picture 37

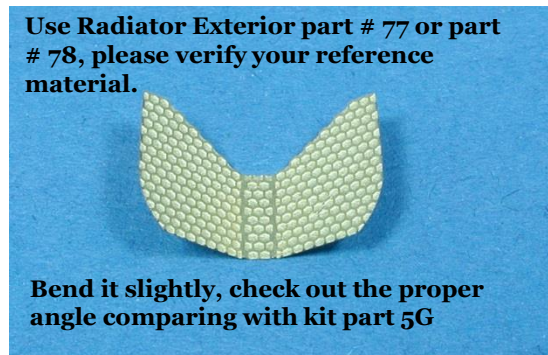

Picture 38

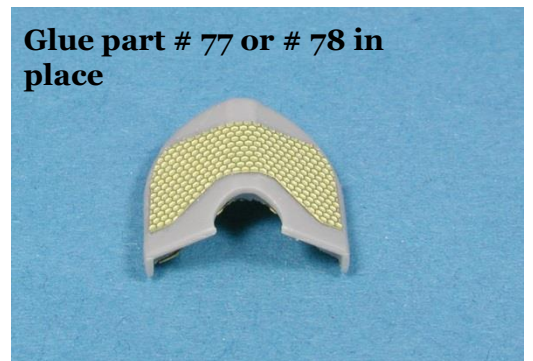

Picture 39

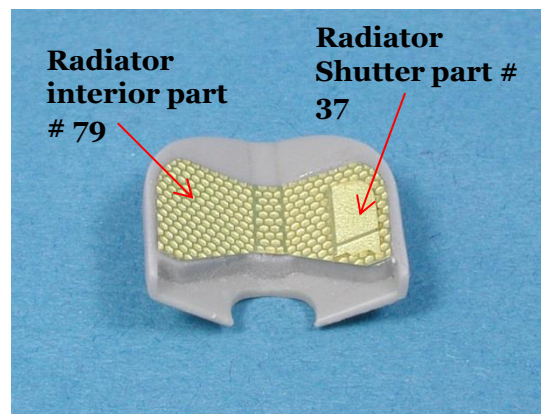

Picture 40

Step 9 Engine Panels

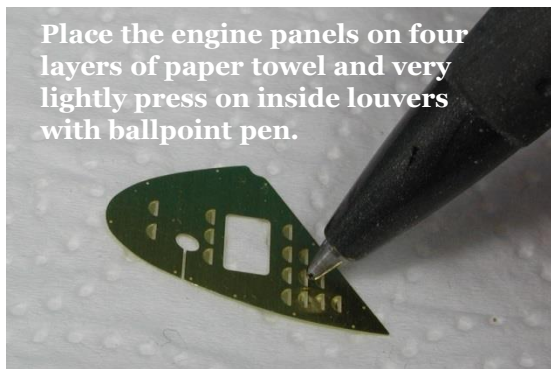

Picture 41

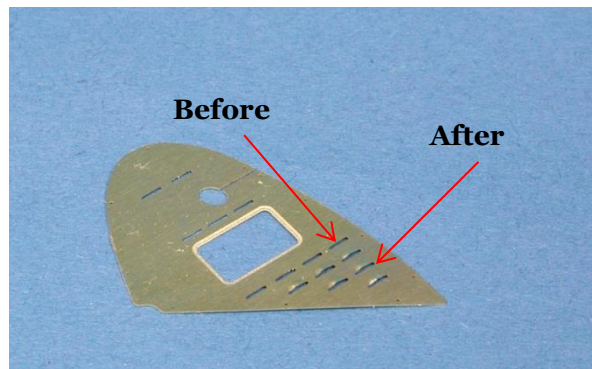

Picture 42

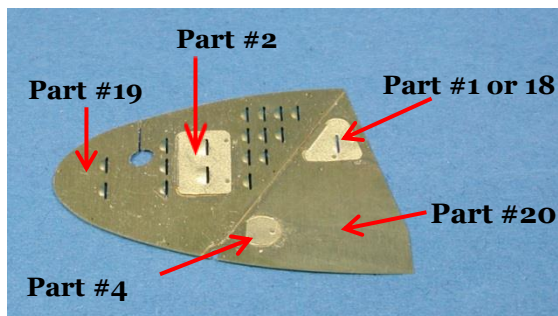

Picture 43

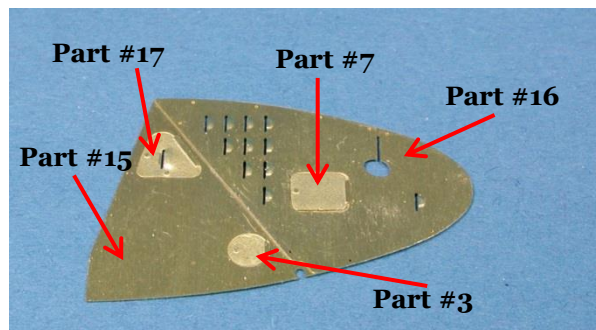

Picture 44

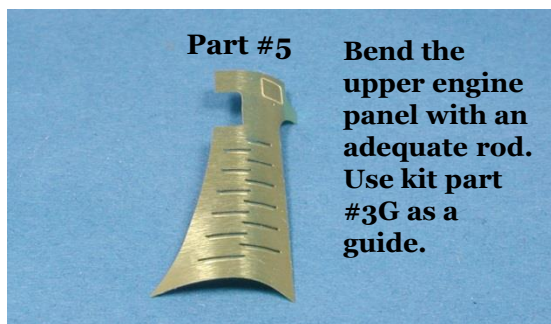

Picture 45

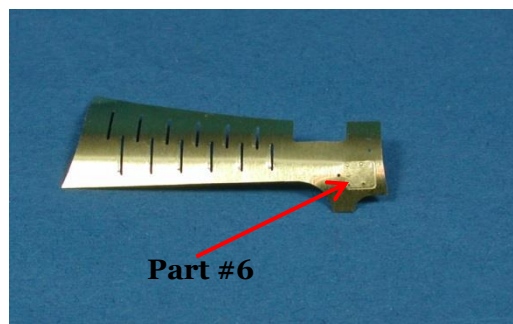

Picture 46

Step 10 Rudder Control Horn

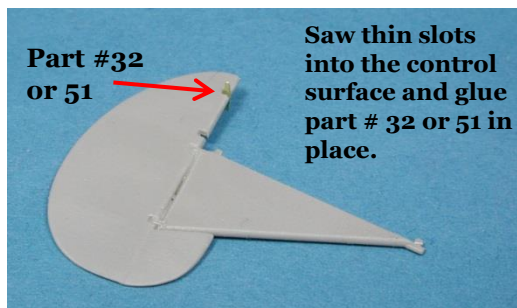

Picture 47

Step 11 Cockpit Details

For rigging with turnbuckles #70 we recommend fine rubber yarn or fishing line.

8x Part #70

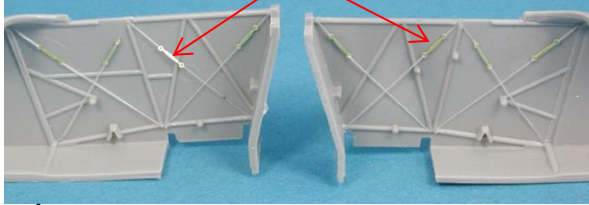

Picture 48

Next Step is something tricky. We recommend to use heated plasticrod for preassembling.

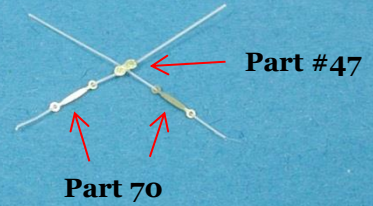

Picture 49

After glueing both fuselage halves together, you will easely add your prepared cross rigging in place.



Picture 50

Remove raised kit details and fill the outer holes

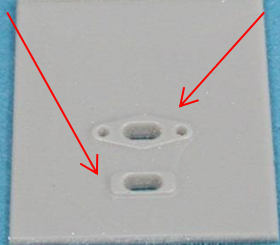

Picture 51

Part #55

Part #58



Picture 52

Glue throttle quadrant in following sequence.

- 1) Part #28
- 2) Part #26
- 3) Part #27



Picture 53

Part #24

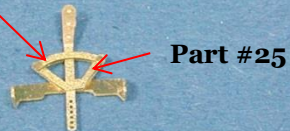

Picture 54

Throttle quadrant on place

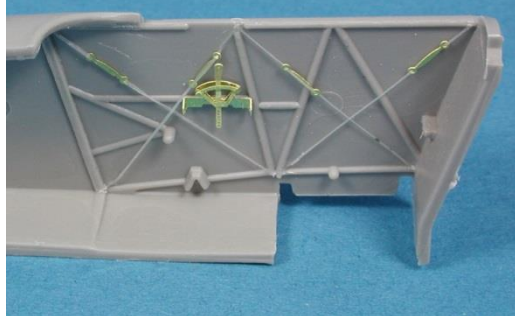

Picture 55

Glue Ignition control in following sequence:

- 1) Part #43
- 2) Part #42
- 3) Part #41

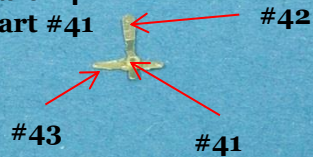

Picture 56

Ignition control on place



Picture 57

Step 12 Instrument Board

Remove raised details of kit part 17B



Picture 58

Glue part #8 first to kit part 17B.

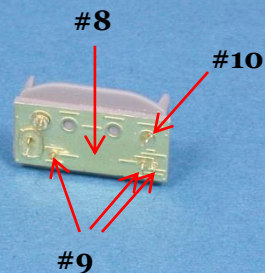

Picture 59

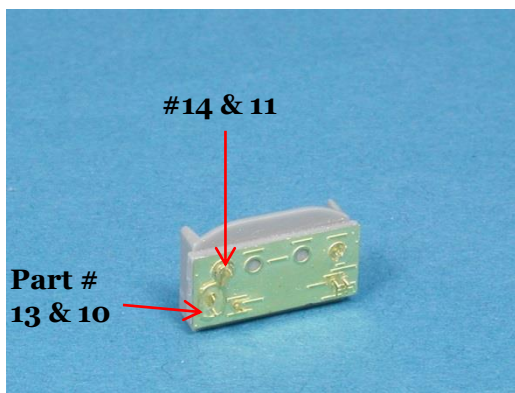

Picture 60

Step 13 Machine Guns (2x)

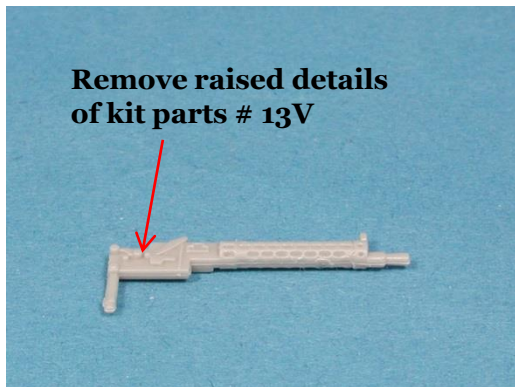

Picture 61

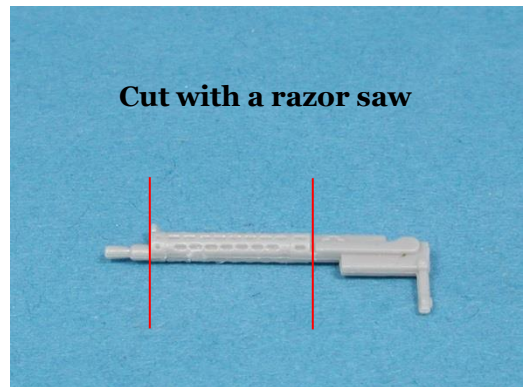

Picture 62

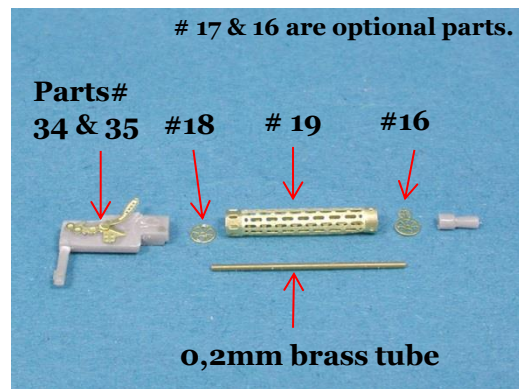

Picture 63

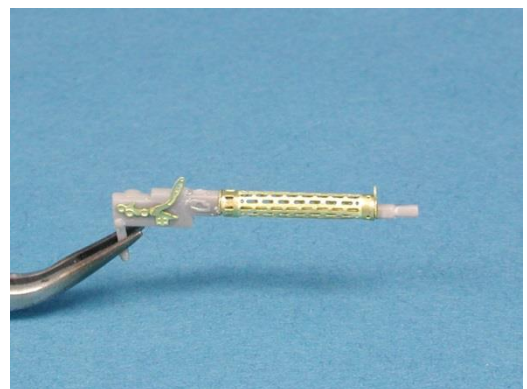

Picture 64



Picture 65

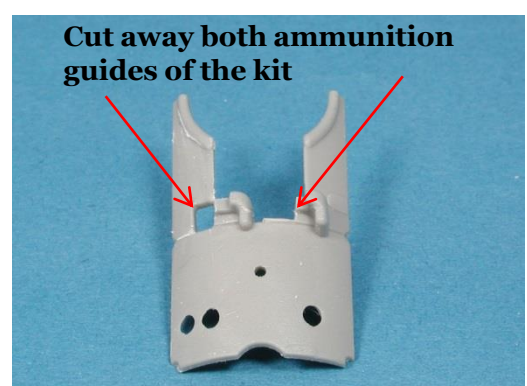

Picture 66

Glue ammunition guide together and insert ammunition belts at last

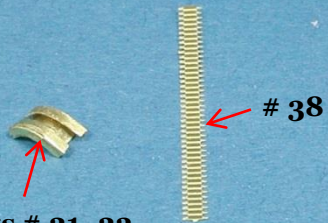

Parts # 21 -23

Picture 67

Bend MG mounting bracket #20



Picture 68

Glue ammunition guide and mounting bracket #20 in place

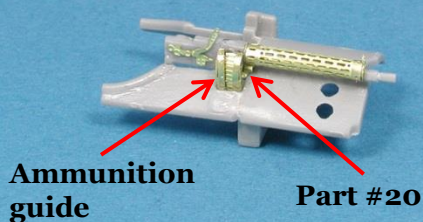

Picture 69

Step 14 Pilotseat

As an alternative use harness parts # 53, 54, 62, 63

Shoulder Harness # 48



Lap Harness # 61

Picture 70

Alternative Step Morell Anemometer

Bend parts #7-8 with a ballpoint pen as shown on picture 41



Picture 71

Anemometer housing itself is not included and has to be scratch built!



Picture 72

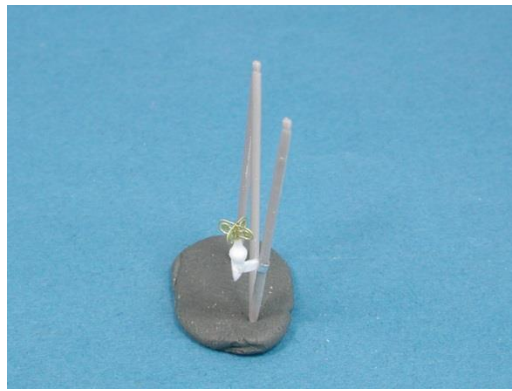

Picture 73

Step 15 Propeller

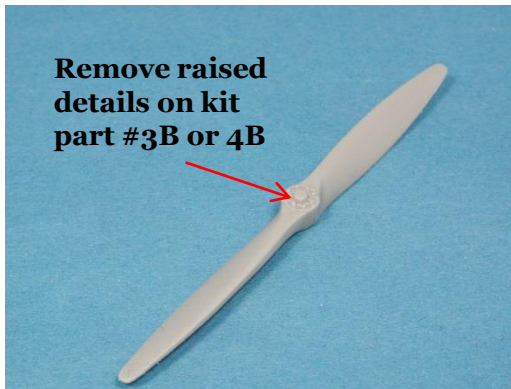

Picture 74

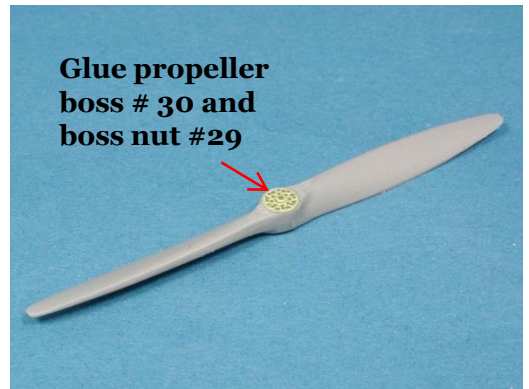

Picture 75

Step 16 Blast Channnels



Picture 76

Step 17 Fuselage Details

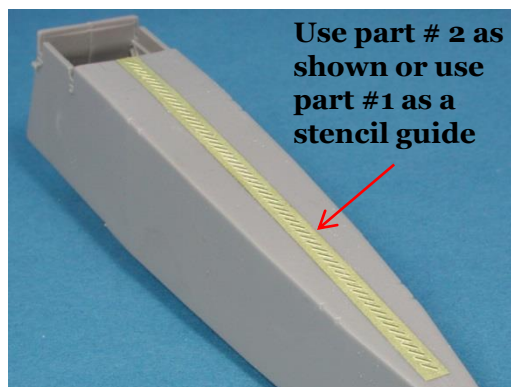

Picture 77

**Remove raised details,
drill proper holes and
glue gromets #5 on both
fuselage halves**

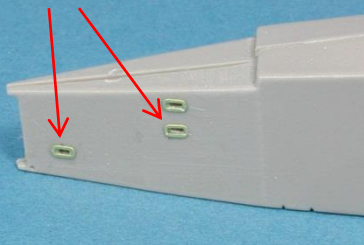

Picture 78

**Add lifting handles
#49 and step #50**

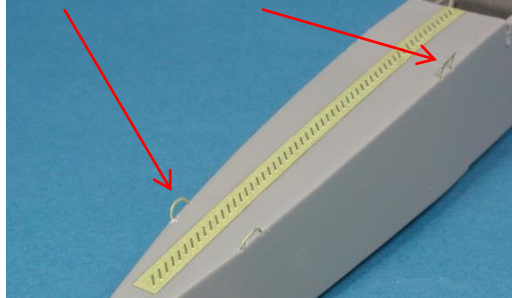

Picture 79

Step 18 Wing Details

**Remove
raised
footsteps
from kit and
replace them
with # 6**

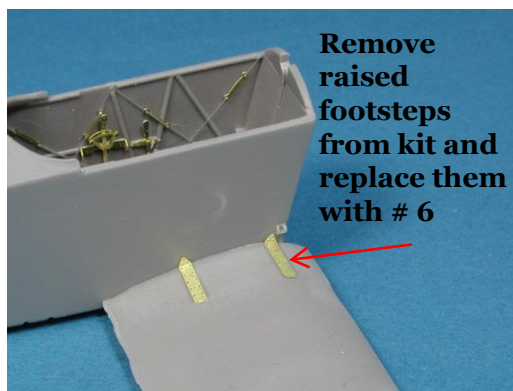

Picture 80

**Bend strut attachment
plates # 14 (4x)**

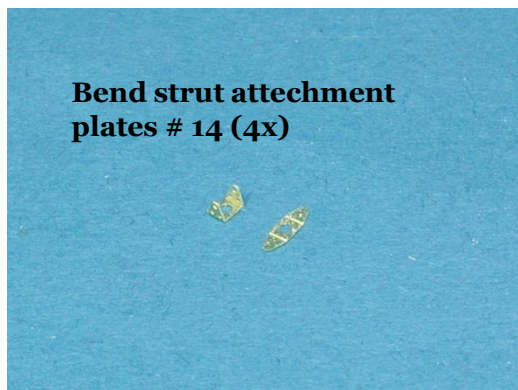

Picture 81

**Remove raised
kit details and
replace with
parts #14**

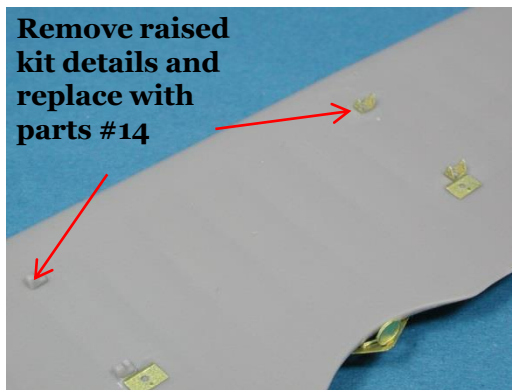

Picture 82

Step 19 Engine Details

**Glue lifter spring caps # 10
on springs of kit part #8V.
Repeat this step on other
side**

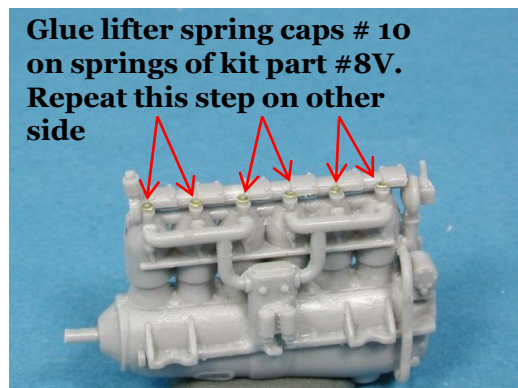

Picture 83

**Saw slots and glue lifters
9 on top! (6x)**

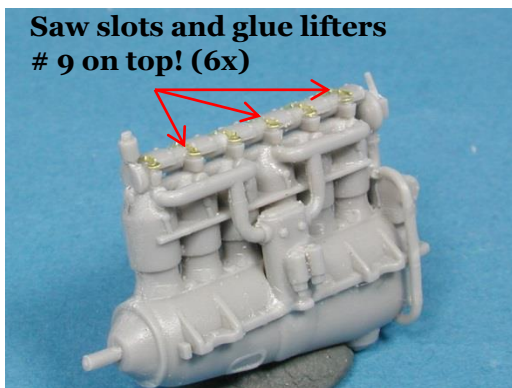

Picture 84